

State of Wyoming Corner Record

(In compliance with the CORNER PERPETUATION AND FILING ACT, Wyoming Statutes, 1977, Section 36-11-101, et, seq., and the Rules and Regulations of the Board of Registration for Professional Engineers and Professional Land Surveyors)

The Reverse side of this form may be used if more space is needed.

The record of the original survey and the citation of the source of historical information (if the corner is lost or obliterated) The description of the corner monumentation evidence as found and/or monument and accessories established to perpetuate the location of this corner. A sketch of the relative location of the monument, accessories, and reference points with course and distance to the adjacent corner(s) (if determined in this survey). The method and rationale for reestablishment of the lost or obliterated corner.

GLO: West on a random line between Sections 18 & 19 at 40.00 chains set temporary 1/4 in old emigrant road runs NW to SE, Intersect West boundary of the Township at 77.00 chains, 28 links North of corner, from which I run N 89°49'E between Sections 18 & 19 at 37.00 Chains set a limestone 18"X12"X5" for 1/4 section corner.

SET: 5/8" X 44" rebar with a 2-1/2" Aluminum Cap 39.876 chains Westerly from from the section corner common to 11/18/19/20.

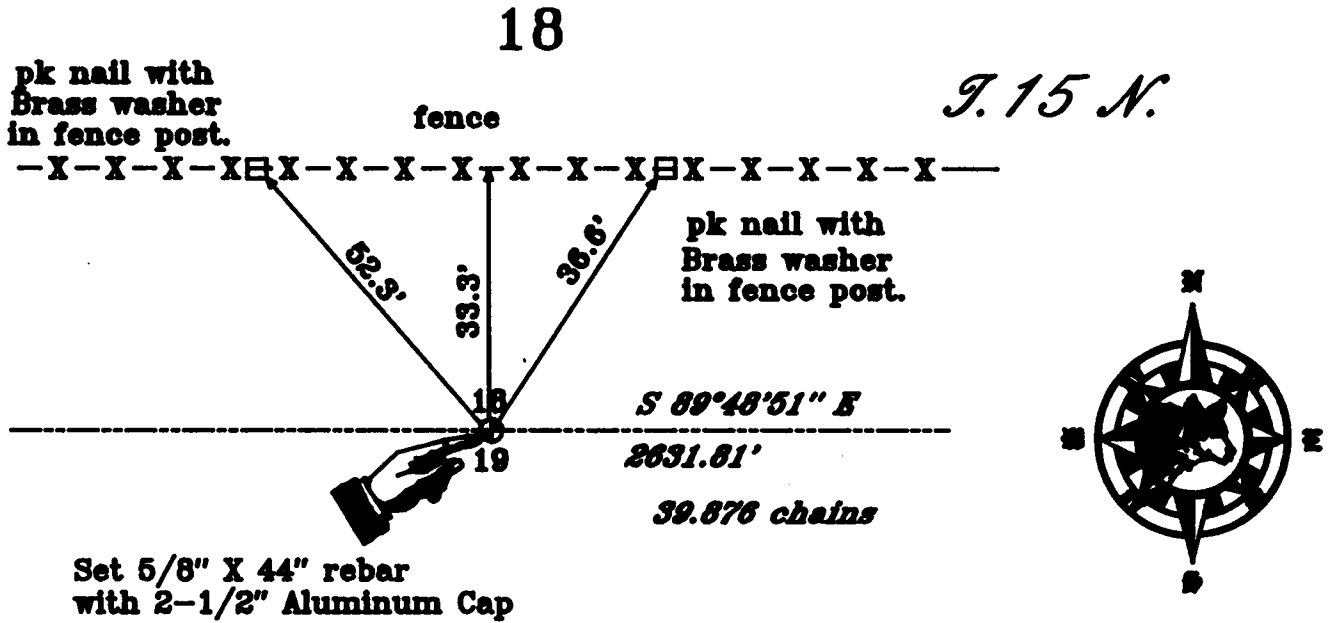

Set 5/8" X 44" rebar with 2-1/2" Aluminum Cap

229044
 ARAMIE COUNTY CLERK
 CHEYENNE, WY.
 98 JUL 6 AM 11 09
 JUL - 6 1998

19

R. 64 W.

Larry T. Perry L.S.
 Gary N. Crisby RIT

Date of Field Work: 28 May A.D. 1998

Office Reference: DEAPLAN

Cross Index Diagram

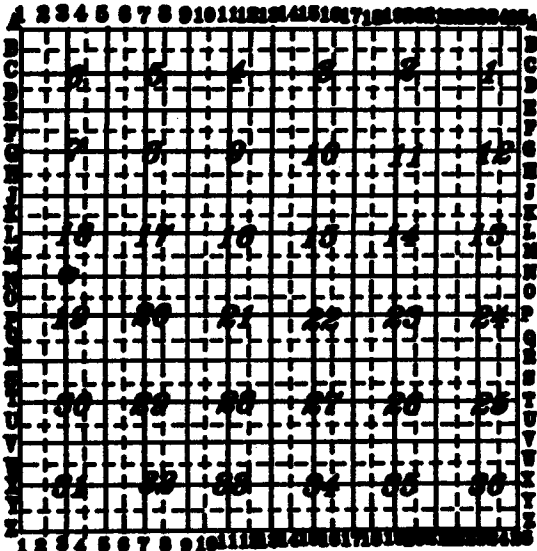

Correstrial Surveying & Mapping Co.
 1187 Terry Ranch Road Cheyenne, Wyoming 82007
 Phone: (307) 634-0300

This corner record was prepared by me or under my direct supervision.

Seal and Signature



Corner Name: 1/4 Section: 19 T. 15 N. R. 64 W. 6th P.M. Cross Index No. N-3